

Small Angle Beam Transducers—North American Standards

Type MSW-QC

Replaceable Wedge 6 mm (.25 in)											
Wedge Angle	A		B		C		D		E		Thread
	mm	in	mm	in	mm	in	mm	in	mm	in	
45°	11.4	.45	19.1	.75	9.4	.37	14.1	0.56	10.7	0.42	3/8 - 32
60°	11.4	.45	21.3	.84	11.2	.44	14.1	0.56	10.7	0.42	3/8 - 32
70°	11.4	.45	25.4	1.00	12.7	.50	14.1	0.56	10.7	0.42	3/8 - 32
90°	11.4	.45	24.1	.95	12.7	.50	14.1	0.56	10.7	0.42	3/8 - 32

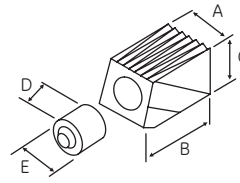

Replaceable Wedge 10 mm (.375 in)											
Wedge Angle	A		B		C		D		E		Thread
	mm	in	mm	in	mm	in	mm	in	mm	in	
45°	14.0	.55	22.6	.89	11.9	.47	14.7	0.58	14.0	0.55	1/2 - 28
60°	14.0	.55	26.4	1.04	14.0	.55	14.7	0.58	14.0	0.55	1/2 - 28
70°	14.0	.55	30.2	1.19	14.7	.58	14.7	0.58	14.0	0.55	1/2 - 28
90°	14.0	.55	29.2	1.15	15.5	.61	14.7	0.58	14.0	0.55	1/2 - 28

Replaceable Wedge 13 mm (.50 in)											
Wedge Angle	A		B		C		D		E		Thread
	mm	in	mm	in	mm	in	mm	in	mm	in	
45°	17.8	.70	26.7	1.05	14.0	.55	16.5	0.65	17.8	0.70	5/8 - 24
60°	17.8	.70	31.5	1.24	16.3	.64	16.5	0.65	17.8	0.70	5/8 - 24
70°	17.8	.70	35.8	1.41	17.3	.68	16.5	0.65	17.8	0.70	5/8 - 24
90°	17.8	.70	35.3	1.39	18.5	.73	16.5	0.65	17.8	0.70	5/8 - 24

Miniature Angle Beam Transducers—Type MSW-QC (Quick Change)

Freq. (MHz)	Element Ø mm	Element Ø in	Order Codes					Accessories	Freq. (MHz)	Element Ø mm	Element Ø in	Order Code					Accessories
			Gamma Series	Benchmark Series	Alpha Series	Standard Wedge (W = 118-340)						Gamma Series	Benchmark Series	Alpha Series	Standard Wedge (W = 118-340)		
1.0	13	.500	241-590	241-591		W-210 30°	Cables BNC 118-140-012	6	.250			W-200 30°	124-591		W-204 90°	Cables BNC 118-140-012	
						W-211 45°						W-201 45°					
						W-212 60°						W-202 60°					
1.5	10	.375	231-590	231-596		W-220 30°	LEMO-1 118-140-022	5.0	10	.375	234-590	W-220 30°	134-591		W-224 90°	LEMO-1 118-140-022	
						W-221 45°						W-221 45°					
						W-222 60°						W-222 60°					
2.25	10	.375	232-590	232-591	132-591	W-223 70°	Wedge Couplant 118-300-740	6	.250		225-591	W-210 30°	125-591		W-214 90°	Wedge Couplant 118-300-740	
						W-211 45°						W-201 45°					
						W-212 60°						W-202 60°					
3.5	13	.500	242-590	242-591	142-591	W-213 70°		7.5	10	.375	235-591	W-220 30°	135-591		W-224 90°		
						W-210 30°						W-221 45°					
						W-211 45°						W-222 60°					
10	10	.375	233-590	233-591	133-591	W-224 90°		10	10	.375	236-590	W-210 30°	145-591		W-214 90°		
						W-211 45°						W-221 45°					
						W-212 60°						W-222 60°					
10	13	.500	243-590	243-591	143-591	W-214 90°		10	13	.500	246-590	W-210 30°	145-591		W-214 90°		
						W-211 45°						W-221 45°					
						W-212 60°						W-222 60°					

Note: Standard wedge angles are specified for carbon steel. Custom configurations are available by special order.